

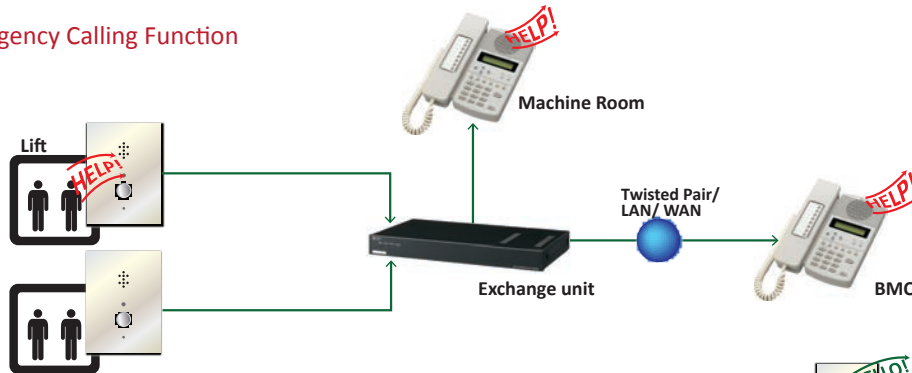

EleVisor 300 (EV-300) is a network intercom system specifically designed for effective communication and monitoring in lift application. It can link up an exchange unit with any combination of dedicated master and door stations over a communication network. The system allows the efficient routing of calls and paging to any number of stations or pre-determined locations.

Employing the sophisticated packed audio technology, the system support high quality of voice communication. For example, its automatic echo cancellation feature provides hands-free duplex conversations between stations without feedback or clipping. The system also comes with a remote monitoring module that can perform self-diagnostic tests on a periodical or scheduled basis.

• Emergency Calling Function



• Paging Function

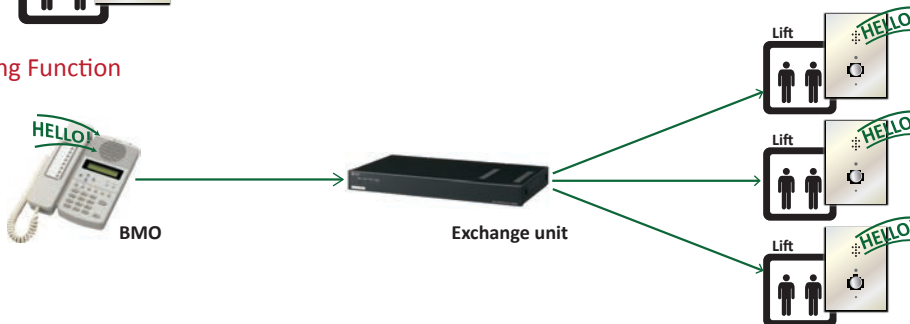

System Features

- System configuration by LAN with monitoring software
- Master-to-Master and Master-to-Sub station communication
- Choice of three wiring configurations: 2-core shielded cables, 2 wires or 4 wires
- Integration with access control, voice alarm, CCTV and other such systems
- Ambient noise control • Time correction
- Operation and stream logs
- System diagnosis

Basic Communication Features

- Handset or hands-free conversation
- Recall • Redial • Camp on busy • Mic-Off
- Remote response • Single-digit dialing
- Call transfer
- Comprehensive call-forwarding features
- Three-party conferencing

Remote Monitoring Module

Once the emergency phone fails to report status within schedule, the monitoring console will send out fault alert through telephone, email and/or SMS to assigned personnel for carrying out investigation.

In case the assigned personnel does not respond within a threshold period, the monitoring console can escalate the alert to the next level of personnel for taking actions. Diagnostic results, fault alerts and notification records are kept in a log for audit purpose in future.

Model **300**

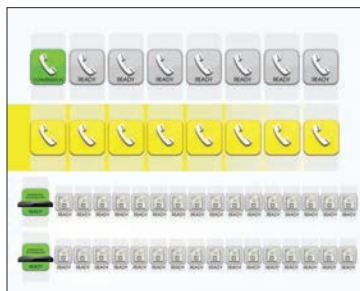

N-8000 - Status Indications

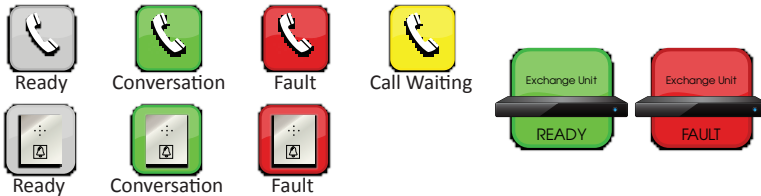

Typical Schematic Diagram

